

TIERNEY ROAD, STREATHAM HILL, SW2
GUIDE PRICE: £450,000 - £500,000



WILFORDS
LONDON

186 Northcote Rd,
London SW11 6RE
020 7361 0410

info@wilfords.com

www.wilfords.com



TIERNEY ROAD, STREATHAM HILL, SW2

GUIDE PRICE: £450,000 - £550,000

543 SQ FT / 50 SQ M

2 BEDROOMS | 1 BATHROOM | 1 RECEPTION | SHARE OF FREEHOLD

Set on the first floor of an attractive Victorian terraced house, this two bedroom apartment comes to market after being expertly renovated by the current owners in the last year.

As you step inside, you are greeted by a spacious living room with a bay window that bathes the space in natural light, creating a warm and welcoming atmosphere. The room is perfect for hosting family and friends, relaxing in the evenings, or entertaining guests. The separate kitchen is equipped with ample storage space and worktops that provide a functional and practical space for preparing meals.

The apartment also boasts two bright bedrooms that are ideal for those who value privacy and comfort. The bedrooms are adorned with large windows. Across from here you will find a family bathroom that offers a shower and a bathtub.

As a share of the freehold, you can rest assured that you have a say in how the property is managed, giving you greater control and flexibility.

The property further benefits from communal off-street parking and a communal rear garden.

SCAN TO VIEW
THIS PROPERTY



Approximate Area = 50.5 sq m / 543 sq ft

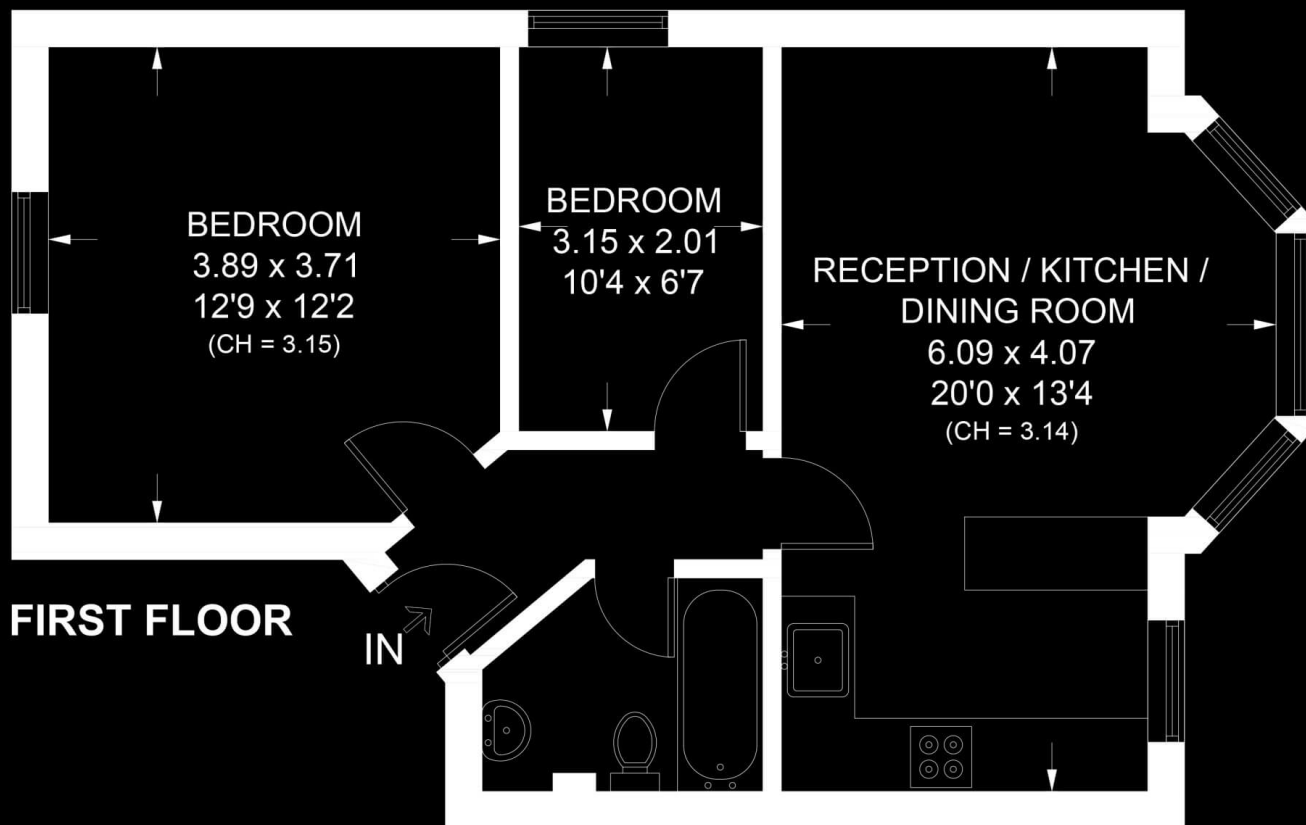

TIERNEY ROAD, STREATHAM HILL, SW2

Floor plan for identification purposes only - not to scale.

Misrepresentation Act 1967. This brochure and the descriptions and measurements herein do not constitute representation, and whilst every effort has been made to ensure accuracy, this cannot be guaranteed.

WILFORDS

LONDON

186 Northcote Rd,
London SW11 6RE
020 7361 0410